



CARBON CERAMIC DERAILLEUR FOR SRAM EAGLE

***GX / X01 / XX1 12 SPEED
MECHANICAL & AXS VERSION***

TOOLS NEEDED

1. Hex Allen Key 3 mm
2. Torque Wrench
3. Chain remover
4. New chain



INSTALLATION VIDEO

For installation tutorial video, please follow the instructions in the "How To Install your Nova Ride Sram GX / X01 / XX1 12 Speed cage" video to properly mount your new cage on our Nova Ride Youtube channel.

Scan this QR Code to access our installation video and social media.



STEP 1

1. Push the cage forward and lock it with the Cage Lock.

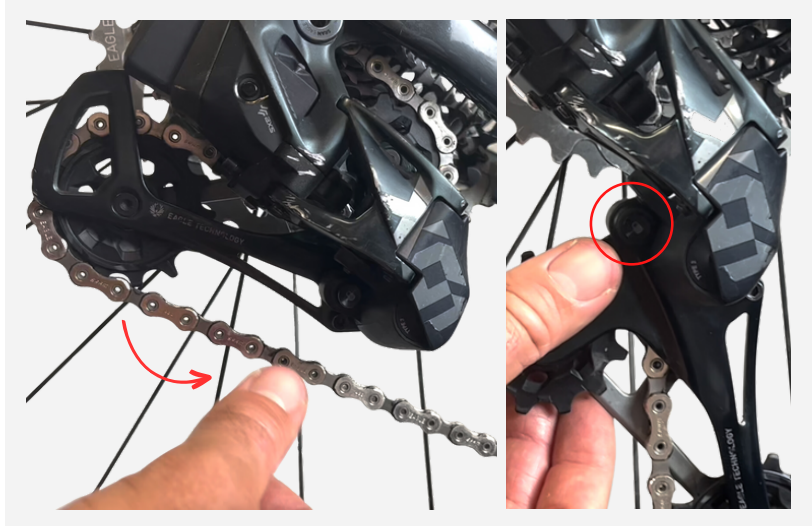

2. Remove the rear wheel.
3. Remove the chain by using the chain remover.
4. Shift the derailleur to the biggest sprocket.

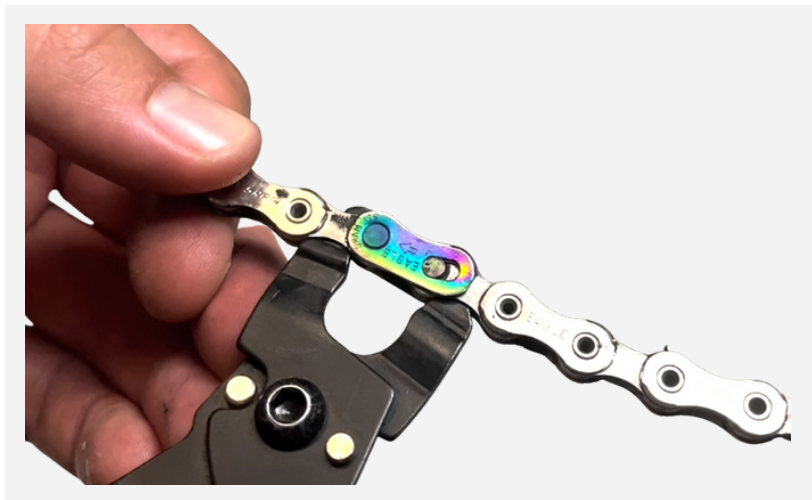

5. Unlock the cage.
 6. Unscrew the stopper and set it aside to reuse later.
- PLEASE NOTE, the cage is under tension, so you have to hold it well.
7. Clock the cage until there is no tension.

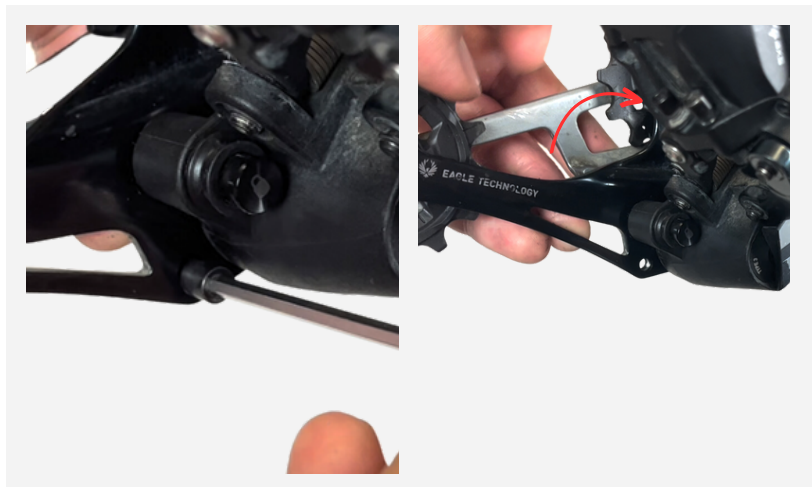

STEP 2

1. Remove the central screw and the SRAM cage.
2. Remove the plastic cap.
3. Set the screw aside to reuse later.



4. Refit the SRAM spring in the derailleur body.
5. Take the cage and align it with the rear of the derailleur.
6. Put the spring rod into the low (L), middle (M) or high (H) tension adjuster on the cage.

L Low = Increases performance and lower chain tension
M Middle = Recommended tension hole
H High = Better shifting and higher chain tension

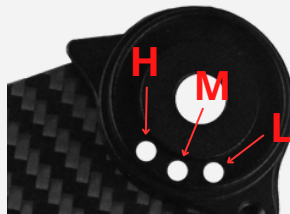
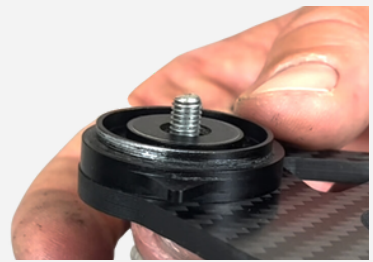

7. Insert and screw the central screw by using the Hex Allen Key.
8. Tighten the screw to 4 N.m by using the torque wrench.

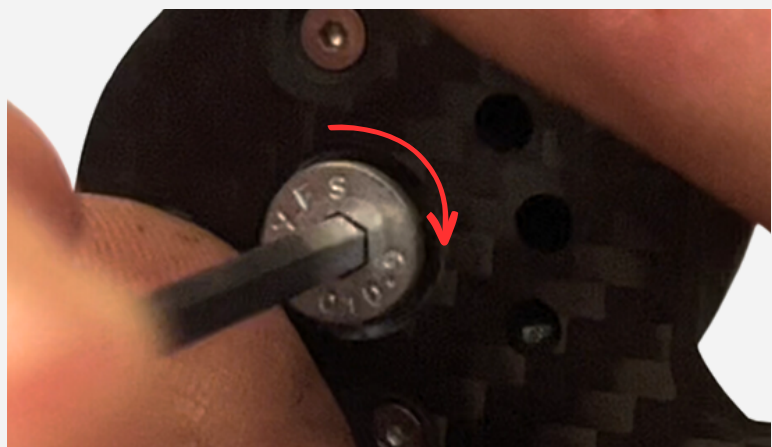

STEP 3

1. Rotate the cage counter clockwise until you can lock it the Cage Lock.
2. Lock the cage.

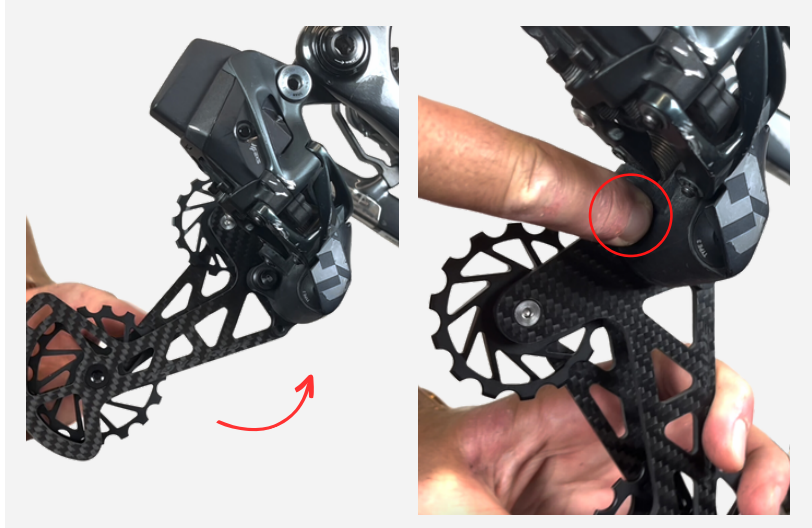

3. Reinstall the stopper by using the Hex Allen Key.



4. Shift your derailleur back down to the smallest sprocket.
5. Reinstall your rear wheel and your chain.
6. Unlock the derailleur cage.
7. Then refer to the next page for your chain length and derailleur adjustment.

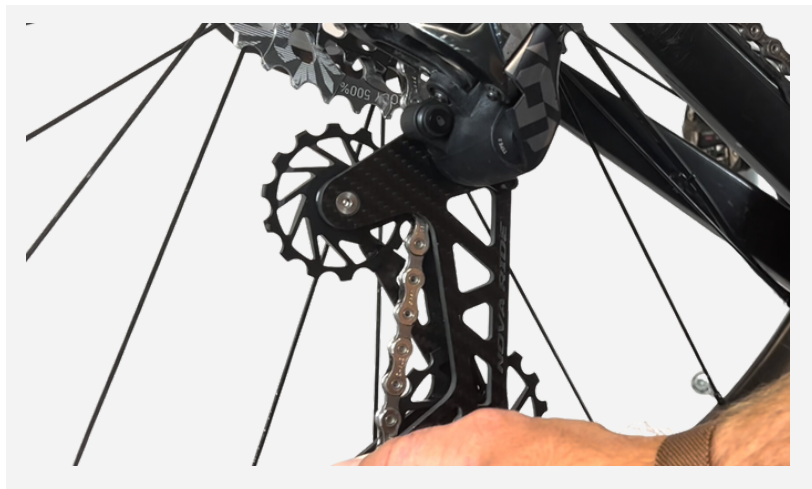

LAST IMPORTANT SETTINGS

To ensure the best riding performance make sure that your new Nova Ride Carbon Ceramic Derailleur cage is mounted correctly.

You can follow the next instructions below or watch our YouTube video tutorial "How To Calculate The Correct Chain Length and Set-up the Gear Shifting": <https://www.youtube.com/watch?v=r1z0D6rfHJA>

CHAIN LENGTH ADJUSTMENT STEPS :

1. The chain length changes because the Nova Ride pulley wheels are bigger. So, it is strongly recommended to use a new chain. We recommend adding 3 to 5 links to your previous chain.
2. Put the chain on the smallest sprocket of your cassette and on the smallest chainring of your crankset.
3. In this configuration, the stopper must not be in contact with the derailleur body. Make sure to let around 1 to 3 millimeters between the two parts.

NOVA RIDE CCD CAGE AND DERAILLEUR ADJUSTMENT STEPS:

1. Put and hold your Nova Ride carbon cage perpendicular to the ground.
2. Then, set with the tension screw the derailleur b-limit gap so that the teeth of the biggest cassette gear is around 5 millimeters from the upper wheel's teeth of your Nova Ride CCD.
3. Now to finish the installation, you only need to check and re-adjust the indexation of your derailleur, this regarding to the Shimano standard and advice.

You are now ready to go! Enjoy your ride with your new Nova Ride Carbon Ceramic Derailleur.

You can review us on Trustpilot : <https://www.trustpilot.com/review/novatoride.com>

MAINTENANCE

No set of rules can be made for how often your part have to be maintained. Our sealed bearings are protected with the alloy covers and enable a longer lifespan. We designed these parts in a way that you will not have to worry about maintenance or technical issues. No lubricants or grease are required to put on the bearings. During your rides, dirt may get between the cover and the bearings, you can remove it with water or a degreaser.

Please note that these are dry bearings, so do not use any lubricant.

WARRANTY TERMS

Nova Ride warrants all products to be free from defects in materials and workmanship. The warranty is effective from the original date of purchase. The warranty covers all Nova Ride products. It is non-transferable and valid to the original purchaser of the product only.

Ceramic Pulley Wheels & Carbon Ceramic Derailleur : 4 years warranty

Any Nova Ride product found to be defective in materials and/or workmanship will be repaired or replaced at the discretion of Nova Ride. It is the sole responsibility of the product's user to inspect and examine the product on a regular basis to determine the need for correct maintenance or replacement.

Not covered under the warranty program : Products determined to be tampered with, modified or neglected, products that have been misused, products in lack of maintenance, products that are subject to normal wear and tear, products affected by a crash or sudden obscure impact, products damaged due to improper installation/reinstallation, products used for any purpose other than the intended use and second hand purchased products.

Fully ceramic sealed bearings so indeed there is no risk of oxidation.

CONTACT

Email for After Sales Service

sav@novatoride.com

Email for Product info

info@novatoride.com

Instagram

nova2ride

Facebook

novaridecomponents

YouTube

Nova Ride

LinkedIn

Nova Ride

ENJOY THE RIDE

